

# Glazpart Link Vent Mk 2

## Achieve higher performance on smaller vents with improved EQA

The design of the Link Vent Mk 2 benefits from aerodynamic features which direct the air flow efficiently through the vents pathway - the canopy extends only 25mm. It has been developed to meet the minimum requirements of the building regulation Part F1:2010; the 2500EQA can be fitted into non habitable rooms such as toilet and bathroom windows which are typically narrower.

The 2500EQA can be used to replace both 2000 and most 4000 vents; it is the same size as typical 2000 vents and has the same, if not improved, EQA as many 4000 vents. The 5000EQA can be used to replace 2 x 4000 vents, meaning fewer vents to fit and rout.

The vent has one of the highest decibel ratings on the market for non-acoustic vents. Improved Db reduces noise to new levels of performance, especially in the closed position. The aesthetically pleasing and patented design helps to reduce the visibility of the trickle vent on a window.

It is available in large range of solid colour or wood grain finishes - internal and external parts can be bought separately for flexible colour choice. The vents are through moulded meaning the colour won't scratch or peel off. Canopies can be vacuum foiled to match embossed Linear wrapped profiles and the vents can be sprayed to any RAL colour.

The vent has no end caps and is supplied with the fixing clips fitted - you can push fit the vent into place within seconds. The clips automatically centre the vent in the rout, ensuring it is fitted level. If you prefer to screw fix your trickle vents, just pop out the fitted screw caps before fitting and fix as normal.

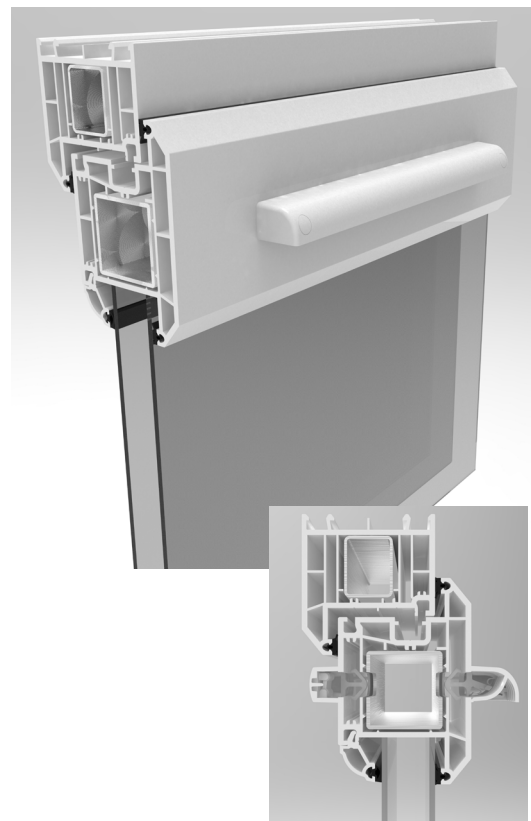

### Key Product Features

- Smallest 2500 EQA & 5000 EQA trickle vents on the market
- Full range of colours which are moulded, colour won't scratch or peel off
- High decibel ratings especially in the closed position: 2500 = 51db and 5000 = 43db
- The low air leakage figures reduces the possibility of drafts or whistling coming from the vents.
- The 2500 can be used to replace both 2000 and most 4000 vents
- The 5000 can be used to replace 2 x 4000 vents

# Technical Information

## LINKVENT MK II: 2500

- **Equivalent Area:** 2500mm<sup>2</sup> EQA
- **Free Area:** 2512mm<sup>2</sup>
- **Acoustic D n,e,w (+/-) - vent open:** 38(0;1)
- **Acoustic D n,e,w (+/-) - vent closed:** 51 (-1;-2)
- **Air Leakage:** 0.39 m<sup>3</sup>/h 0.11 L/s
- **Watertightness Test to BS EN 13141-1:** Resistant to water penetration using method 1A meeting Class 9A requirement up to and at 600pa in BS EN 12208
- **DB Rating:** Airbourne sound insulation to BS EN ISO 10140-1:2016 Annex E and BS EN ISO 10140-2:2010 and single number calculated in accordance with BS EN ISO 717-1:2013

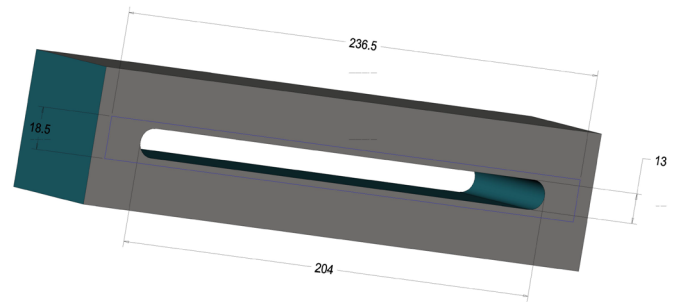

Internal				External								Ventilator			
Ventilator				Canopy				Grille (Timber, Sliding Door, Sash)				Ventilator			
H (mm)	L (mm)	D (mm)	Weight (gram)	H (mm)	L (mm)	D (mm)	Weight (gram)	H (mm)	L (mm)	D (mm)	Weight (gram)	Attachement Type	Rout H (mm)	Rout L (mm)	Stand W (mm)
18.5	236.5	15	30	18.5	236.5	25	30	26	236.5	2.5	11	Clip or Screw	13	204	NA

## LINKVENT MK II: 5000

- **Equivalent Area:** 5000mm<sup>2</sup> EQA
- **Free Area:** 5049mm<sup>2</sup>
- **Acoustic D n,e,w (+/-) - vent open:** 35(0;1)
- **Acoustic D n,e,w (+/-) - vent closed:** 43 (0;0)
- **Air Leakage:** 1.29 m<sup>3</sup>/h 0.36 L/s
- **Watertightness Test to BS EN 13141-1:** Resistant to water penetration using method 1A meeting Class 9A requirement up to and at 600pa in BS EN 12208
- **DB Rating:** Airbourne sound insulation to BS EN ISO 10140-1:2016 Annex E and BS EN ISO 10140-2:2010 and single number calculated in accordance with BS EN ISO 717-1:2013

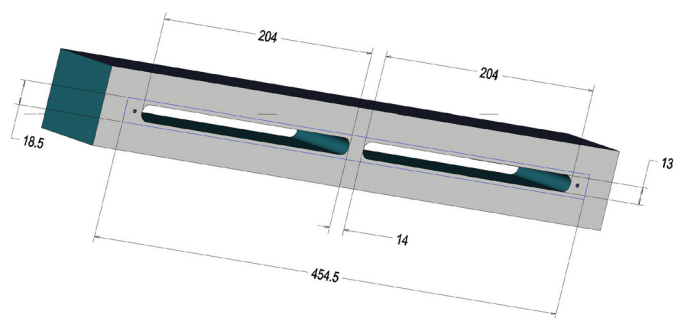

Internal				External								Ventilator			
Ventilator				Canopy				Grille (Timber, Sliding Door, Sash)				Ventilator			
H (mm)	L (mm)	D (mm)	Weight (gram)	H (mm)	L (mm)	D (mm)	Weight (gram)	H (mm)	L (mm)	D (mm)	Weight (gram)	Attachement Type	Rout H (mm)	Rout L (mm)	Stand W (mm)
18.5	454.5	15	60	18.5	454.5	25	49	26	436	2.5	20	Clip or Screw	13	422	14